

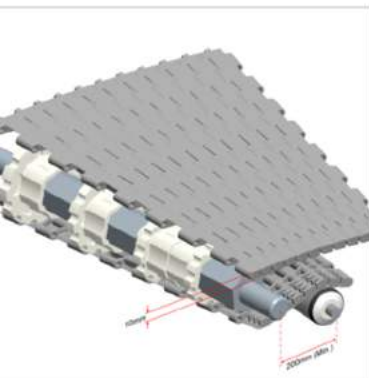

บริษัท คอนเวเยอร์ไกด์ จำกัด  
**CONVEYOR GUIDE CO.,LTD.**

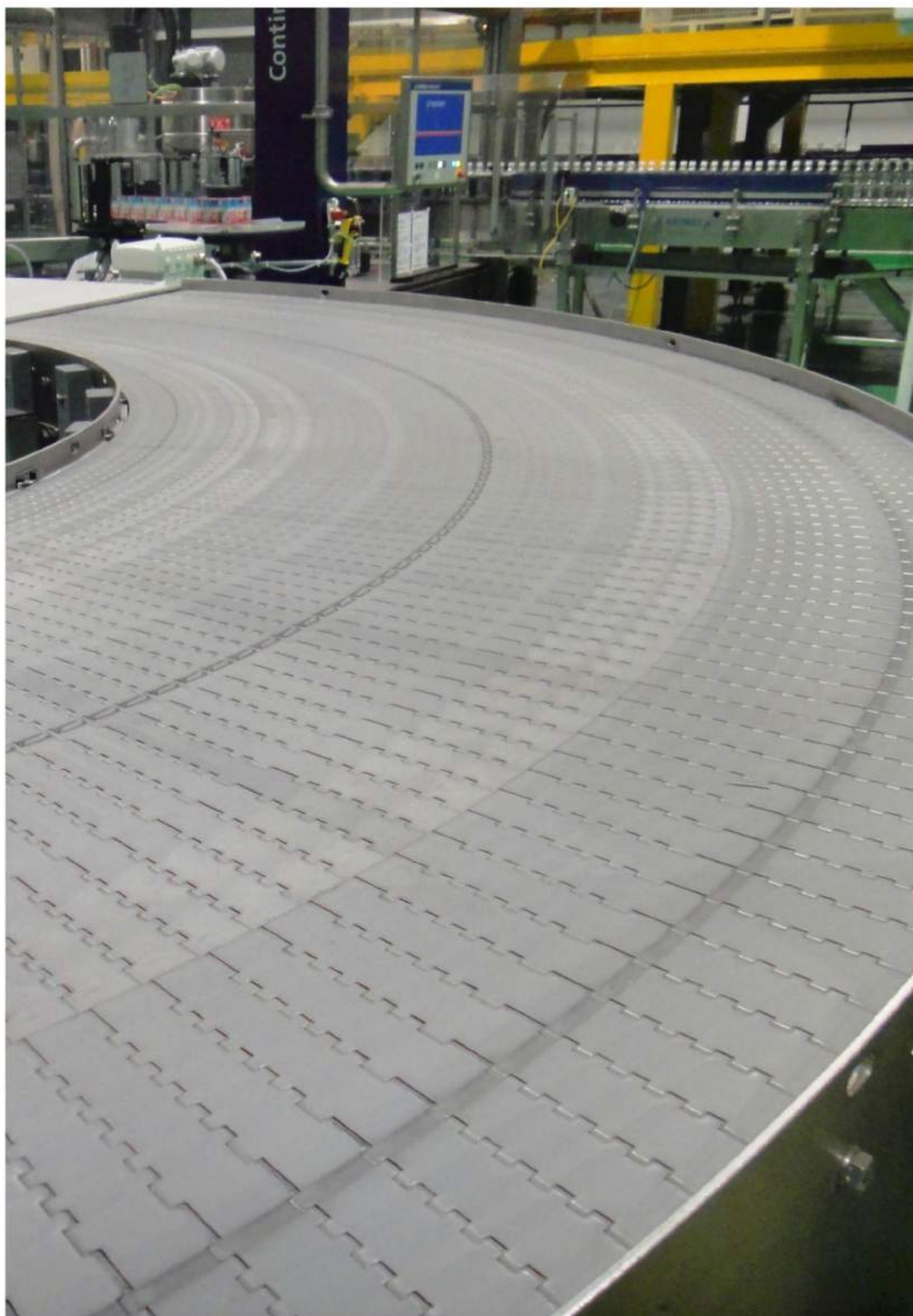

**Product: Modular Plate Turning Conveyor**



### **Innovative product of turning conveyor**

Do you still worry about the difficult replacement of turning conveyor belt?

Do you still worry about the slow ordering of turning conveyor belt?

Are you still angry with easy deformation of traditional PVC turning conveyor belt and easy crack of joint parts?

Are you still fearful of sudden failure of turning conveyor belt?

Do you still worry about the slow conveying speed and light load of turning conveyor?

Do you still attempt to make turning conveyor belt resist chemicals, low temperature, and high temperature?

### **Now, I can tell you for sure that the new generation of turning conveyor has emerged ultimately!**

For logistics transportation, HONGSBELT International (HK) Limited has developed the turning conveyor with modular conveyor belt. HS-2000A turning module plate conveyor belt will not change the inner-edge radius because of the width of conveyor belt, that is to say, it will not increase the inner-edge radius due to the increase of the width. The inner-edge radius is only 600mm, and it uses the interval of 200mm as the extension width. Due to the maximum width of 1,000mm, total load of one ton, and maximum speed of 120m, it can meet the requirements of conveying height in the airport, and even meet extensive logistics transportation demands. It can achieve all-round transportation such as 30, 45, 60, 90, 120 and 180 angles of turning conveyors.

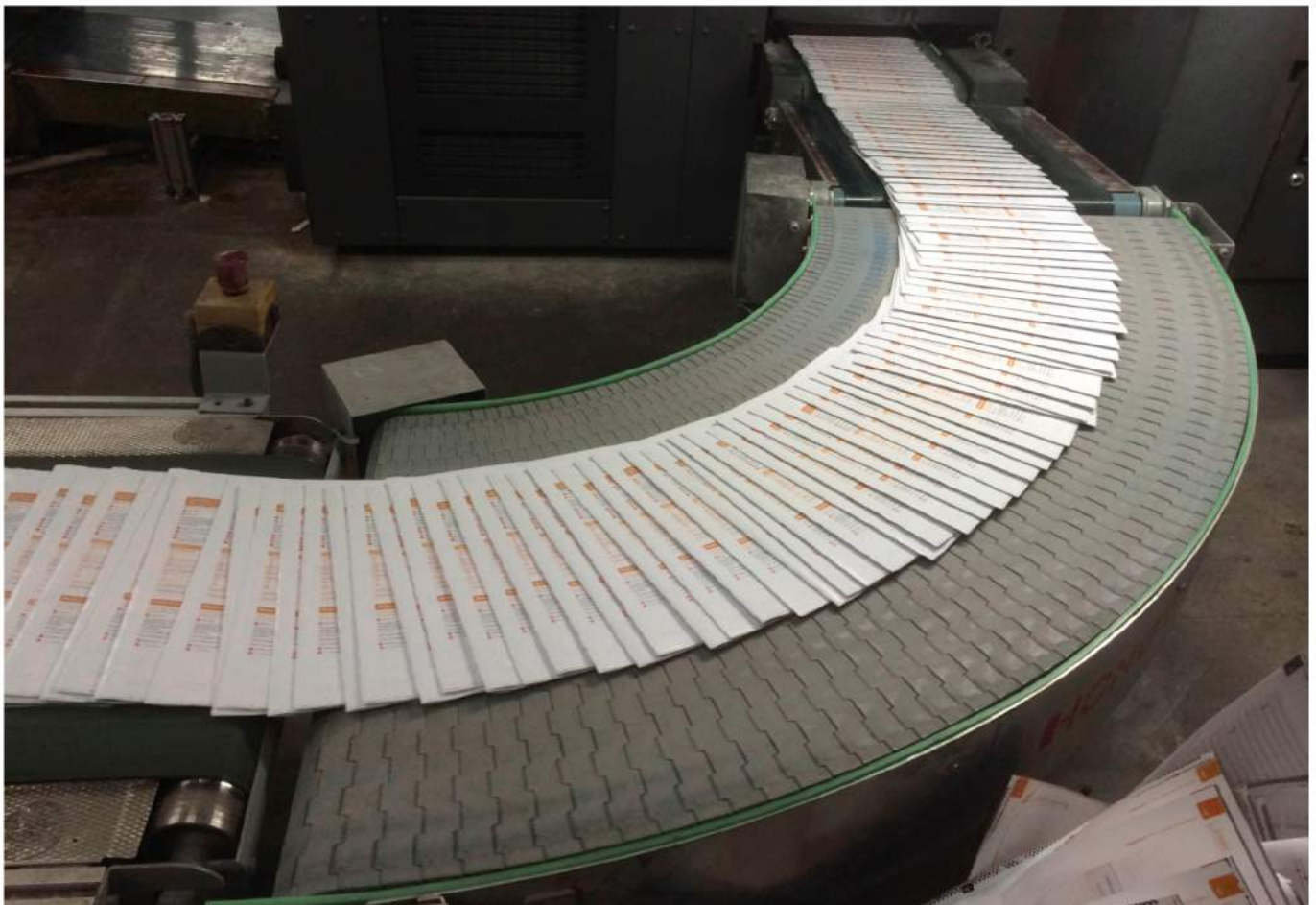



## Advantages of modular plate turning conveyor

HS-2000A modular plate turning conveyor belt, due to stable operation and fixed structural design, can avoid the disadvantages that general turning modular belt must appear straight section at the driving end.

HS-2000A modular plate turning conveyor belt can replace the redundant straight section design with various included angles, so it can save the manufacturing cost. Meanwhile, the assembly line can save the space to the maximum degree.

HS-2000 modular plate turning conveyor belt uses gear drive, and the belt itself adopts special composite plastic material (we also can develop new materials according to actual needs, such as: acid/alkali-resistance, high-temperature resistance, low-temperature resistance, and antistatic materials, etc.),

It can withstand instant shocks, featuring low-friction coefficient and tensile strength 10 times greater than general PVC turning conveyor belt; it uses gear drive, so it can bear high speed and heavier loads, suitable for paper-making, printing, beverage and packaging. Therefore, it is the ideal choice for you to maintain the stable assembly line.

## Successful Application case

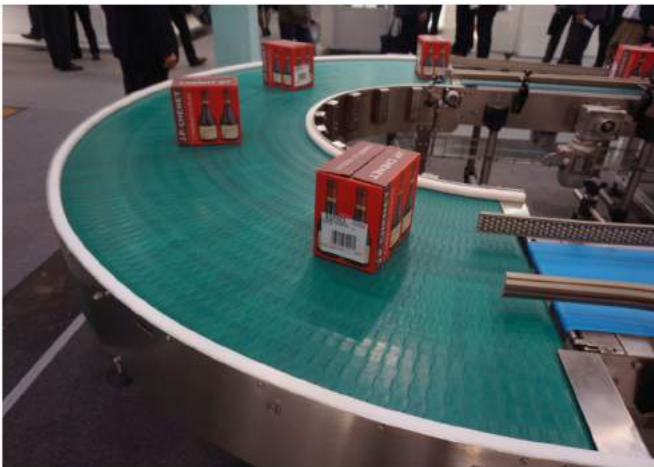



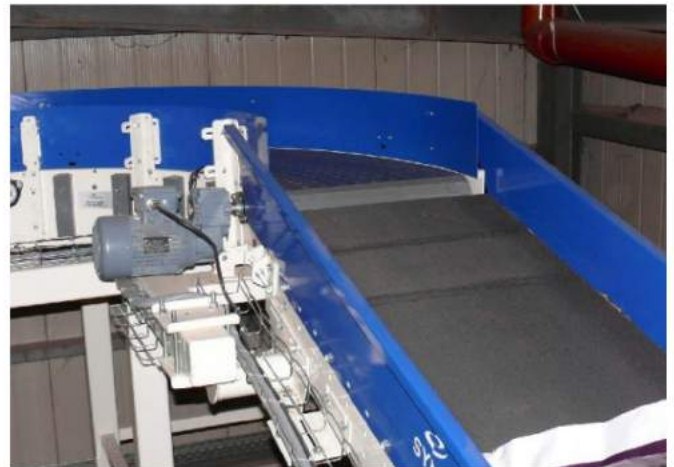
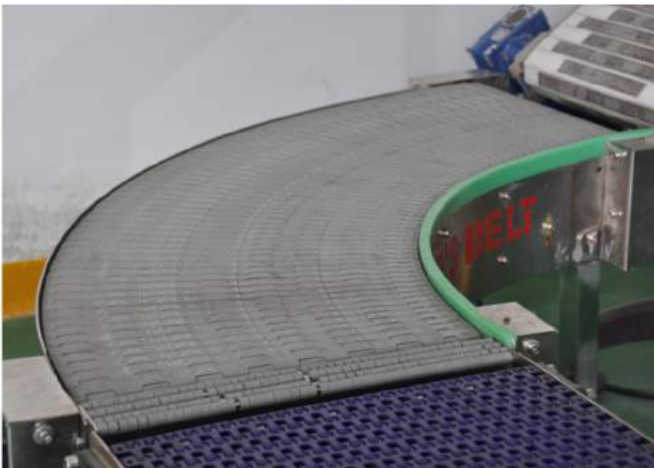



## Comparison with traditional PVC turning conveyor and roller turning conveyor:

A. Traditional PVC turning conveyor: Due to unstable bearing parts and fragile PVC conveyor belt, the service life is short, and conveying structure is very tremendous. What's more, it uses smooth roller as the drive, so it is easy to appear low tension and slipping, which might not be used normally and even affect the production. Due to sudden fracture of unstable PVC conveyor belt and instability of the belt, it often appears belt bending and deviation phenomena.

B. Traditional roller turning conveyor: Due to unstable bearing parts and fragile roller, the bearing's service life is very short and the noise is massive. Too large interval between the rollers can directly affect the limitation on transportation. Especially at the transportation of some chemical products, it is more likely to corrode the rollers, generate a large number of costs for the replacement of parts, and add a number of redundant production costs.

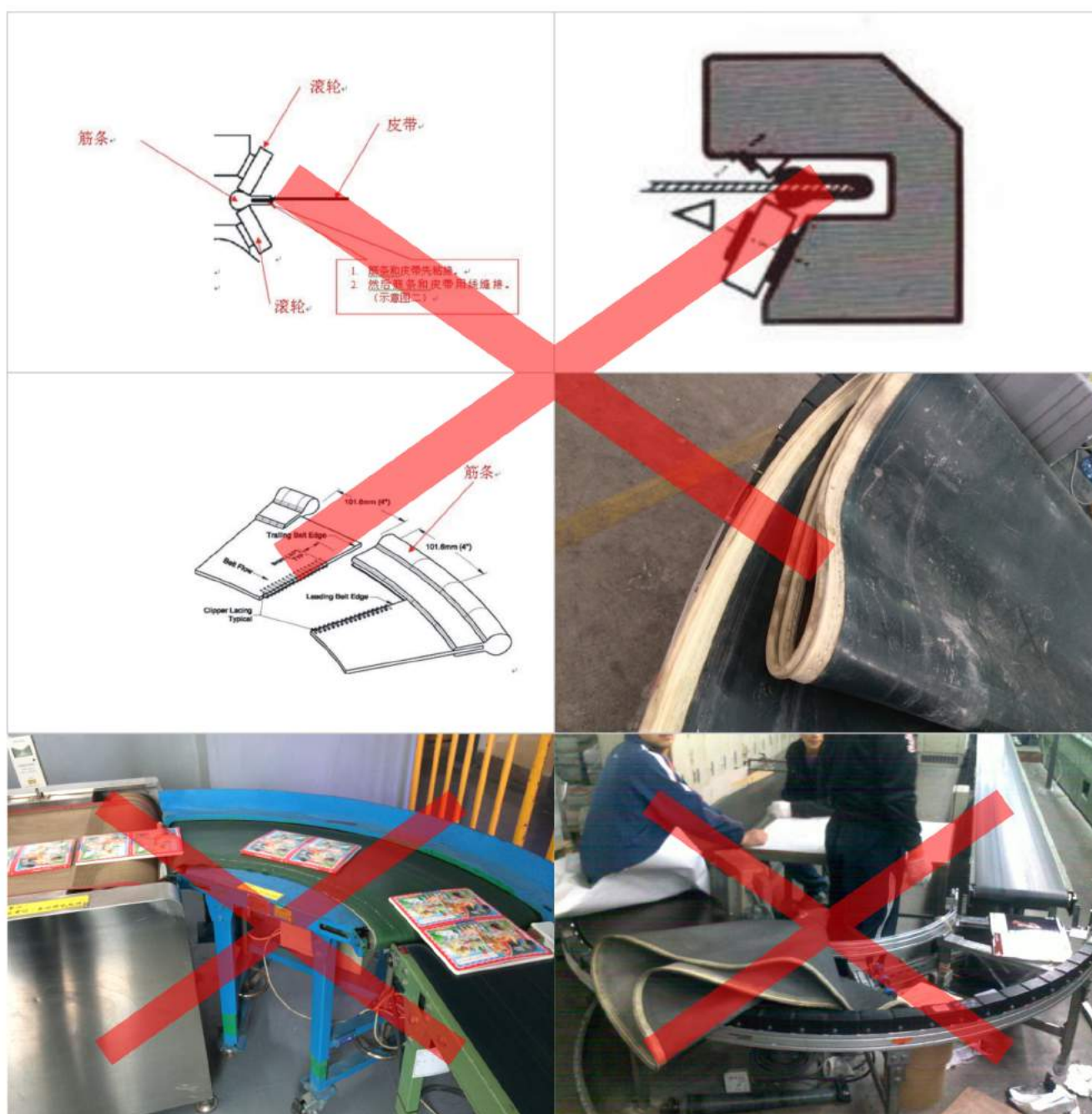

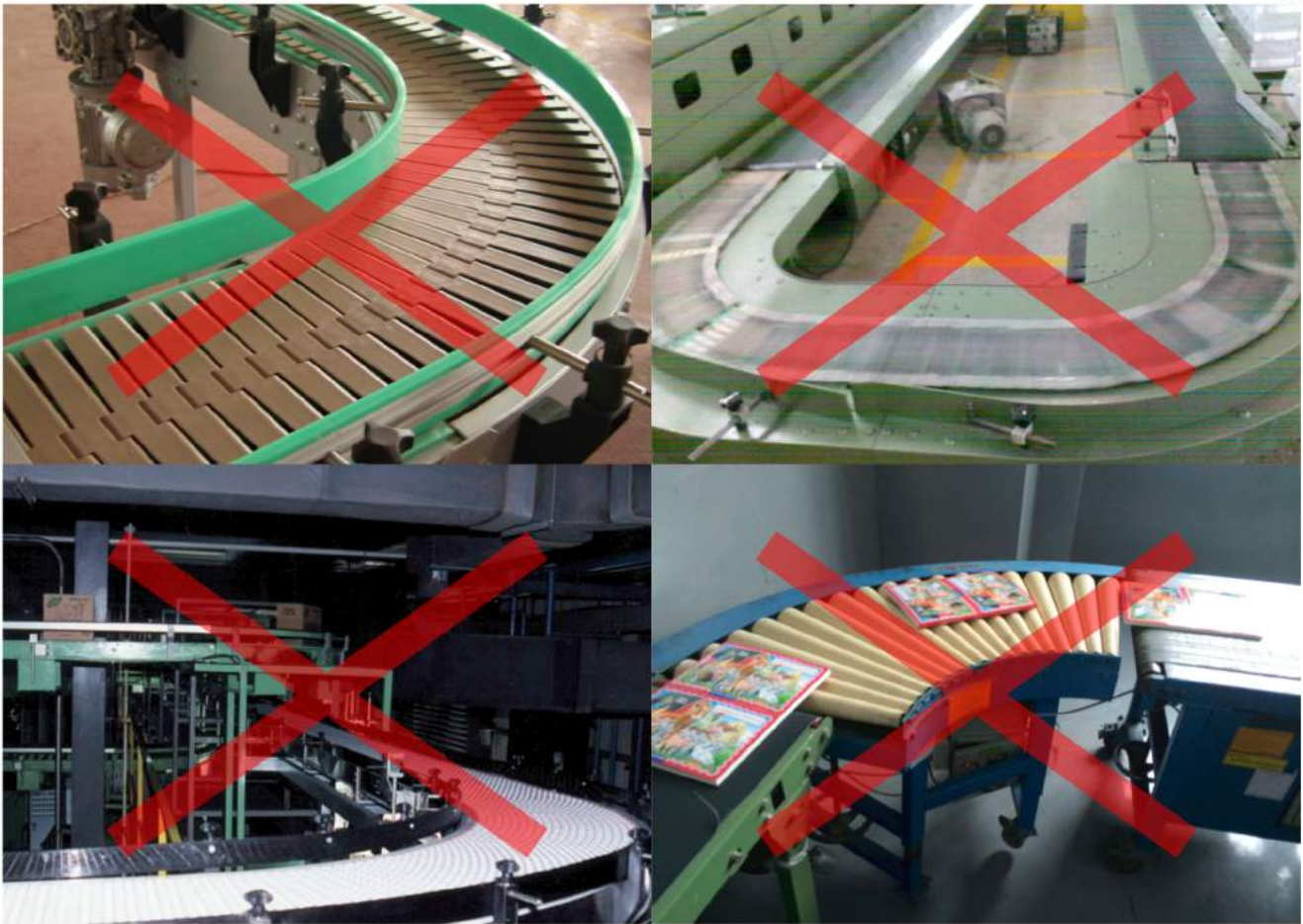

HS-2000A modular plate turning conveyor, developed by HONGSBELT International (HK) Limited., characterized by modular structure design, gear drive and non-slipping conveyer belt, can maintain the most stable operation state in the conveying process. The drive gear shaft hole adopts hexagonal design with 41.5mm parallel opposite side, and uses 41mm hexagonal shaft steel as the drive shaft. In addition to convenient raw materials and processing, it has no floating effect like quadrangle shaft caused by key string movement, thus the operations are more stable.

## Modular Plate Turning Conveyor belt-----Technical sheet of HS-2000A

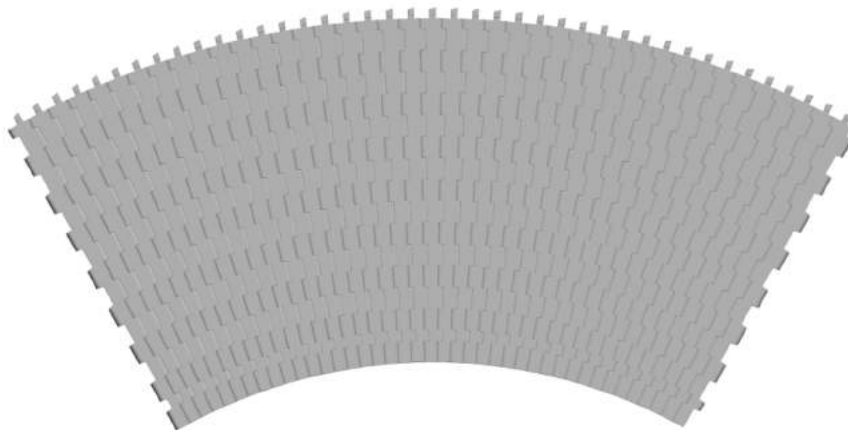

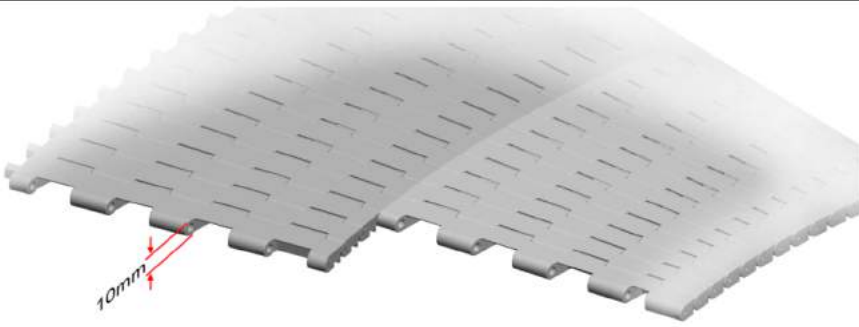

Fixed Radius: 600mm Minimum Width: 200mm Open Area: 0% Approved: FDA Rod: Ø 4.5mm Flight: No Side Guard: No Curve : Yes	
--	--

## Data

Belt Material	Belt Strength		Temperature	
	Straight		℃ (min.)	℃ (max.)
	Kg/M(BW)	N/M(BW)		
Polypropylene	1600	16000	1	100
Polyethylene	1550	15500	-60	60
Acetal	2640	26400	-40	80
Nylon	2230	22300	1	180
BW – Belt Width				

## Color Table

Polypropylene					Polyethylene					Acetal					Nylon				
W	G	N	DB	B	W	G	N	DB	B	W	G	N	DB	B	W	G	N	DB	B
●	●						●			●				●				●	

W-White, G-Gray, N-Nature, DB-Dark brown, B-Blue

## Friction Table

Belt Material	Friction Wear strips & Products							
	UHMW	HDPE	Steel	Glass	SUS	Plastic	Cardboard	Aluminum
Polypropylene	0.32	0.24	0.15	0.09	0.13	0.08	0.15	0.25
Polyethylene	0.13	0.11	0.26	0.19	0.31	0.16	0.21	0.41
Acetal	0.11	0.09	0.27	0.16	0.26	0.15	0.19	0.28
Nylon	0.18	0.13	0.25	0.16	0.26	0.16	0.19	0.27

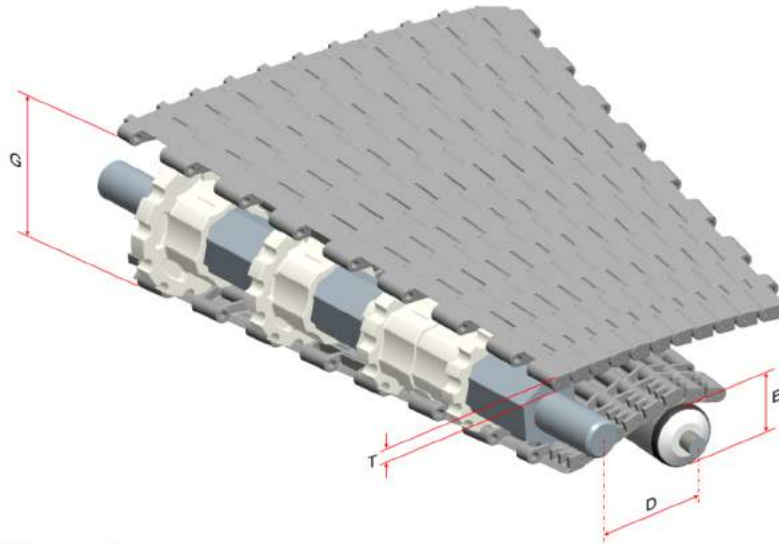

### Conveyor Frame Dimensions

Unit : mm

No. Teeth	D ( Min.)	E ( Min.)	G	T
12	200	40	5.6°	10

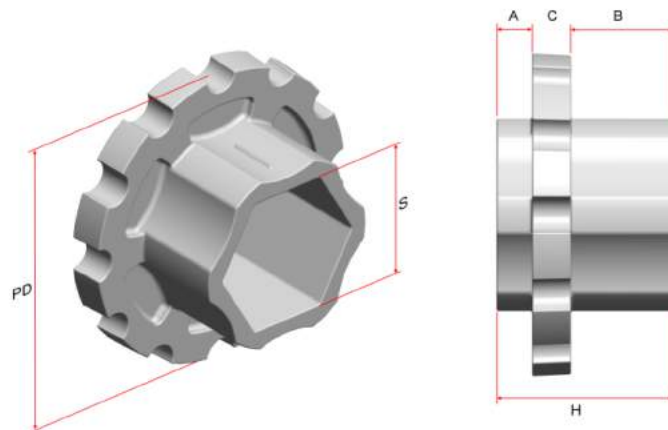

### Sprocket Dimensions

Unit: mm

Belt Width	Sprocket No.	PD	S	A	B	C	H
200	1	65	41.5	35	0	11	46
	2	72		10	29		50
400	3	82		10	29		
	4	92		10	29		
600	5	101		10	29		
	6	111		10	29		
800	7	121		10	29		
	8	130		10	29		
1000	9	140		10	29		
	10	150		10	29		



## Installation of sprockets

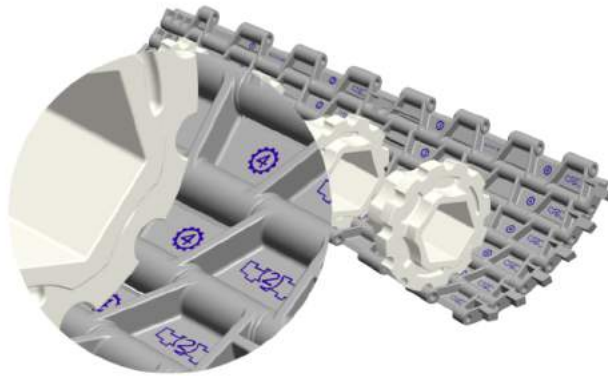

Please install the sprockets according to the graphical representation.

## Driving Mode of HS-2000A

For turning conveyors installed with traditional PVC conveyor belt, the belt is fixed with unstable bearing parts, so the lift time of it is very short and the structure of the conveying machine is large; At the same time, the belt is drive by smooth roller, so it is easy to slip, which causes the low tension force and usually affects the production.

HS-2000A Flat Top Radius Modular Conveyor Belt is designed with module structure, and is drive by sprockets, which solve the slip of belt and ensure the belt in most stable condition in operation.

The bore of HS-2000A sprocket is 41.5mm hexagon, it can be matched with 41mm standard hexagonal shaft, so it is easy to get and process the raw material, more importantly, this design solves the chordal action of quadrilateral shaft and brings more stable operation.

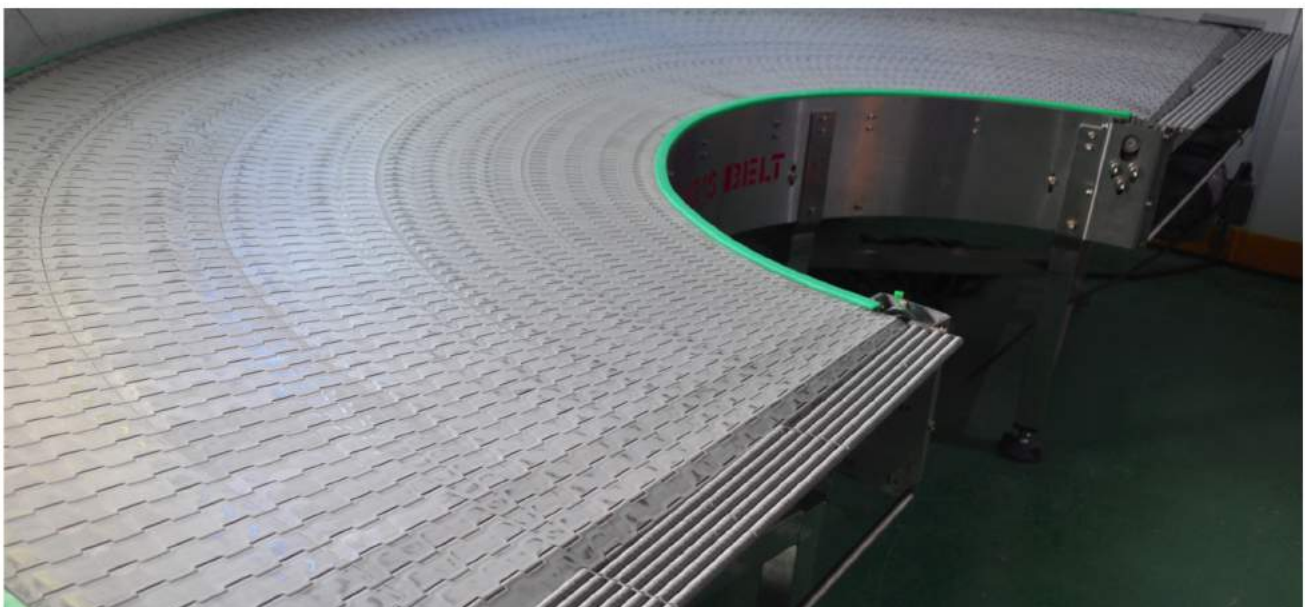

## Guide Rail & Wear Strips

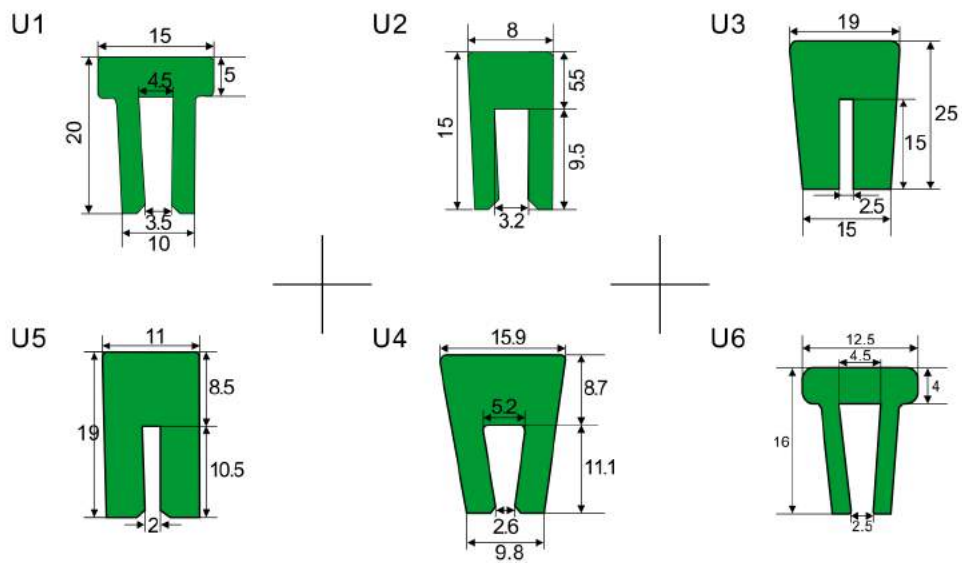
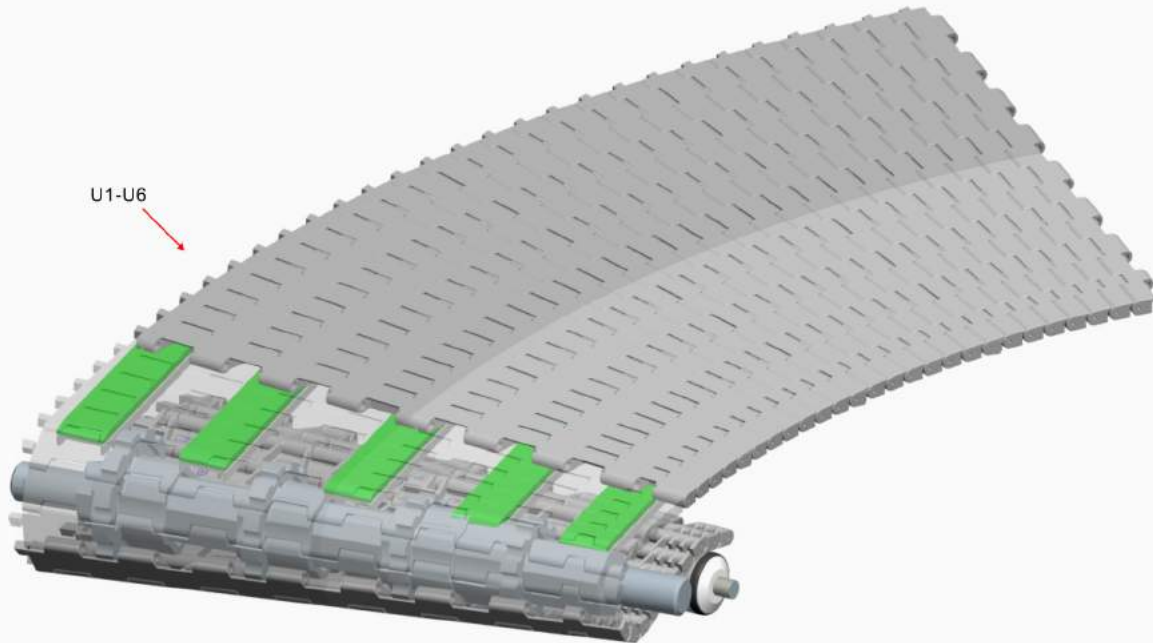

- We have different kinds of guide rail and wear strips for your choice; for more information, please consult our sales team.



## **HS-2000 series of new conveyer products are undergoing.**

### **1.HS-2000B Flush Grid Modular Plate Turning Conveyor belt**

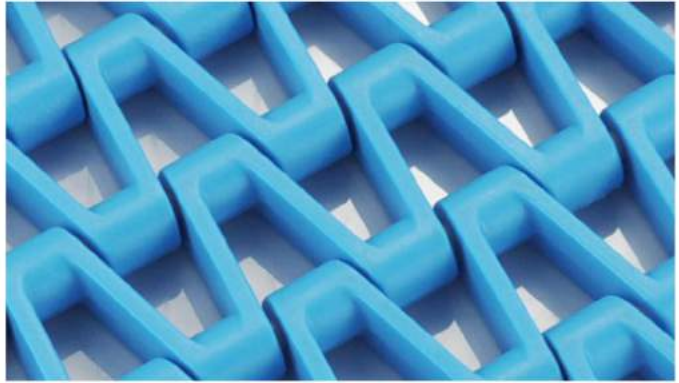

### **2.HS-2000EL Rubber Modular Plate Turning Conveyor belt**



### **3.HS-2000D Pattern Modular Plate Turning Conveyor belt**



## **Service & Guarantee**

New products and for more information,  
welcome to visit our website :  
[www. hongsbelt. com. cn](http://www.hongsbelt.com.cn)



## SERIE HS-2000A Questionnaire

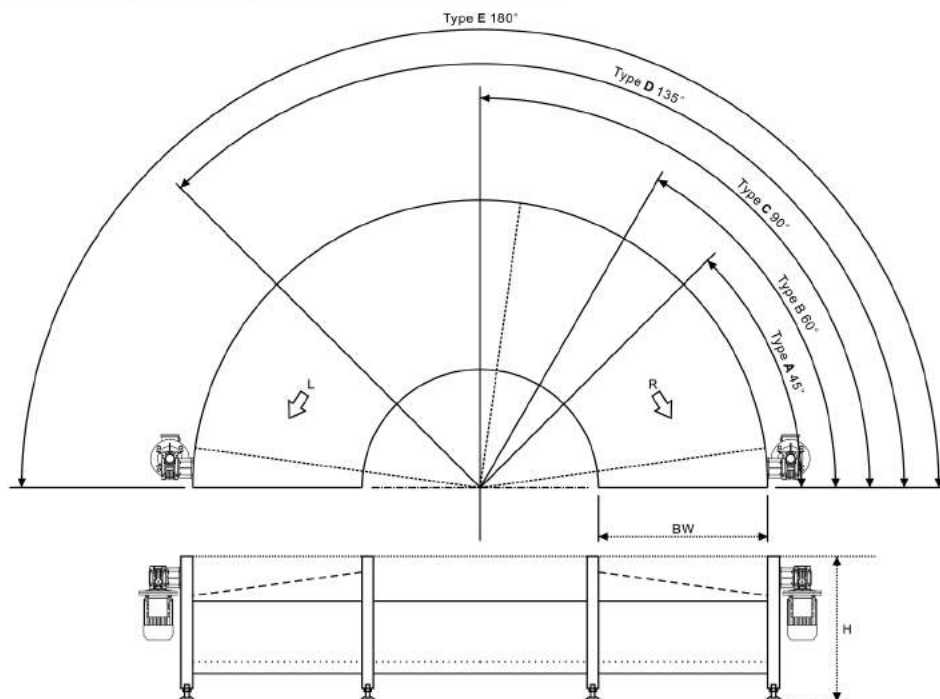

■ Please choose your conveying angle and fill in model code: ☐A, ☐B, ☐C, ☐D, ☐E, and describe various parameters according to the following sequence.

1. BW : ☐200mm ☐400mm ☐600mm ☐800mm ☐1,000mm

2. H1: \_\_\_\_\_ mm

3. Weight: \_\_\_\_\_ kg (single piece)

4. Maximum Load: \_\_\_\_\_ piece (total load)

5. Package: \_\_\_\_\_ (description)

6. Maximum speed: \_\_\_\_\_ M/minute

7. Operating temperature \_\_\_\_\_ °C

8. Voltage and current: \_\_\_\_\_ V \_\_\_\_\_ Hz

9. Need to change the speed ☐ Yes ☐ Fixed speed \_\_\_\_\_ M/minute

10. Instant start frequency: ☐ Frequent ☐ Not frequent \_\_\_\_\_ times/day

11. Conveying direction: ☐ R ☐ L

12. Conveyer material: ☐Stainless steel ☐Carbon steel paint

13. Key notes: \_\_\_\_\_



บริษัท คอนเวเยอร์ไกด์ จำกัด  
**CONVEYOR GUIDE CO.,LTD**

E-mail: [info@conveyorguide.co.th](mailto:info@conveyorguide.co.th)

[www.conveyorguide.co.th](http://www.conveyorguide.co.th)

Line ID: @cg1356 Tel: 090-907-6077 , 02-992-1025 / Fax.02-992-1022

